

# *Prescription Preferences*

## ***Step-by-step Guide***

# Prescription Preferences

## How to Use – Setting up your Prescription Preferences

### Step 1



From the Home screen, select Prescription Preferences at the bottom of the screen.

# Prescription Preferences

## How to Use – Setting up your Prescription Preferences

### Step 2



Click on Add Rx to create a new Prescription Preference

Click on the edit button to edit an existing Prescription Preference

Click on the + button to see an expanded view of the saved Prescription preference.

# Prescription Preferences

## How to Use – Setting up your Prescription Preferences

### Step 3

West Coast Practice

Key Step: 3 of 3

### Add New Prescription Preference

What name would you like to give your new prescription?

Diagnosis (optional)

Please Select

#### SHELL MODIFICATIONS

Shell Rigidity  
Semi-Rigid

Shell Length  
Mid Length    Full Length

1st Ray Cut Out  
Flexible Morton's Ext  
Semi-Rigid Morton's Ext

Cancel    Save

Give the new prescription a name

Select the design features for the prescription

Click Save

# Prescription Preferences

## How to Use – Setting up your Prescription Preferences

### Step 4



After hitting Save you will be returned to the Prescription Preference home screen.

If it's not correct, click the edit button to adjust the prescription.

Click on + to review that the prescription was entered and saved correctly.

If correct, click on Back to return to the Home screen

# Prescription Preferences

## How to Use – Applying your Prescription Preferences

Step 1 – Follow your normal new patient flow



Start a new Session



Enter the patient's information Hit Next



Scan the patient's feet Hit Next

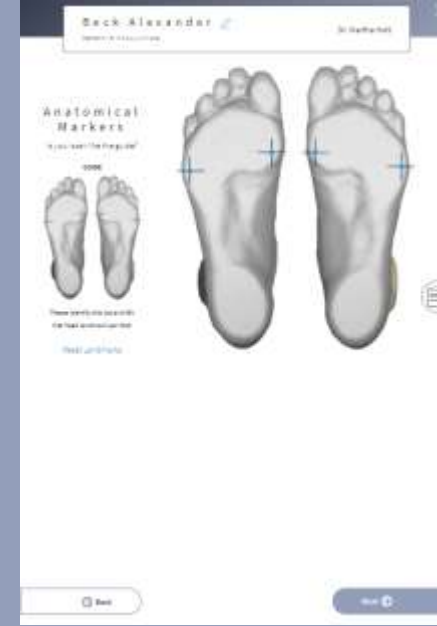

Select the anatomical markers Hit Next

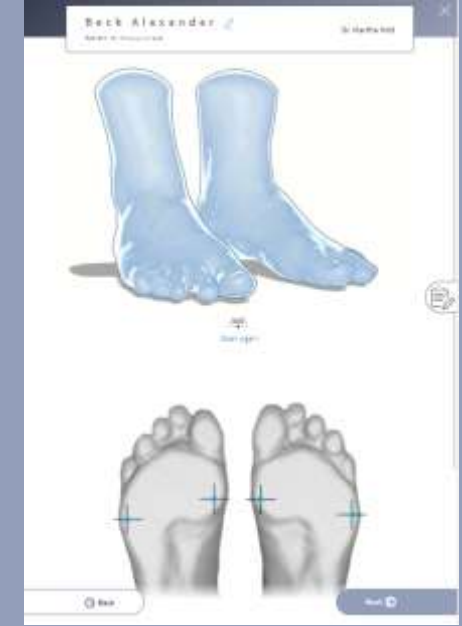

Review the scans and Hit Next

# Prescription Preferences

## How to Use – Applying your Prescription Preferences

### Step 2 – Select Functional Orthotic



Select Functional Orthotic



Do not select the Sports, Stability, Everyday Comfort or Dress style. The Prescription Preference features is not available with these predefined styles.

# Prescription Preferences

## How to Use – Applying your Prescription Preferences

### Step 3 – Select the prescription preference you want to use

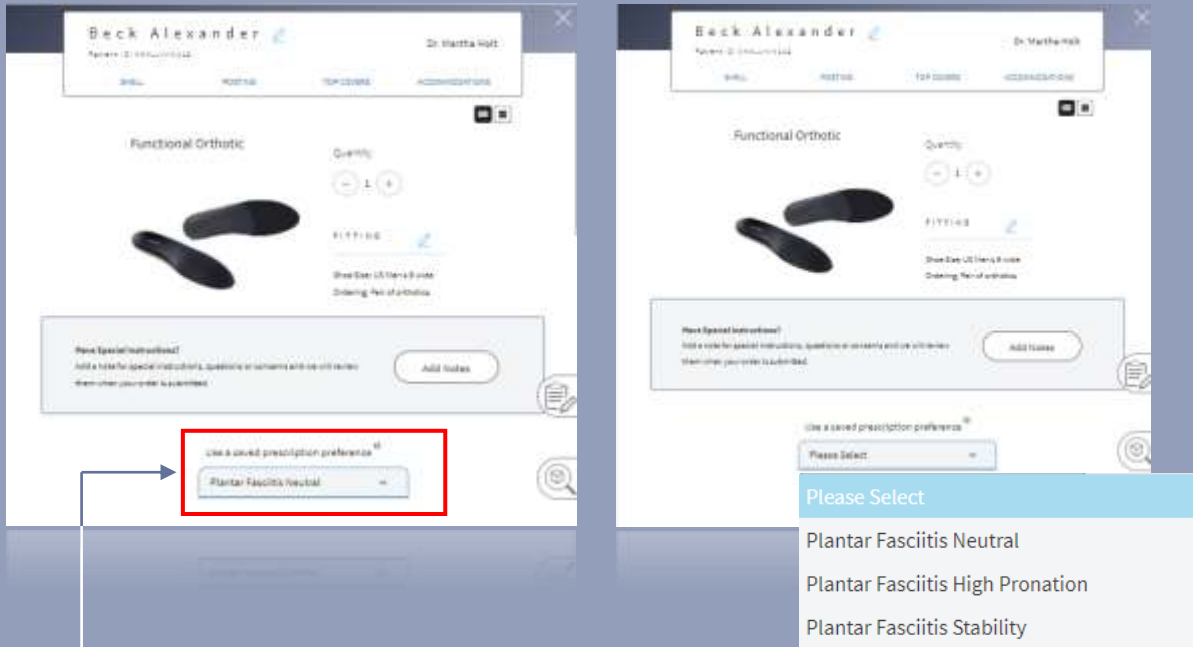

Select On the Prescription Page, under the “Use a saved prescription preference” click on the down arrow to see a list of your saved Prescription Preferences.

Select the correct prescription

The saved prescription settings will now apply to the entire prescription



# Prescription Preferences

## How to Use – Applying your Prescription Preferences

### Step 4 – Review and edit the preferences

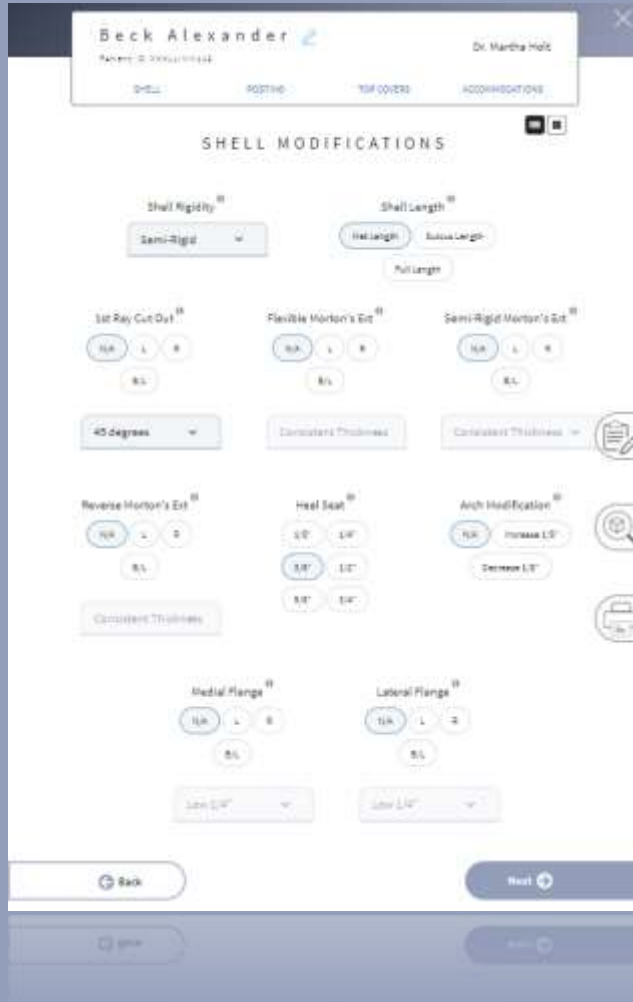

You can make any changes to your saved Prescription Preference if desired.

Any changes made on this screen will not override the saved Prescription Preference settings you created.

If correct, click Next

# Prescription Preferences

## How to Use – Applying your Prescription Preferences

### Step 5 – Submit Order

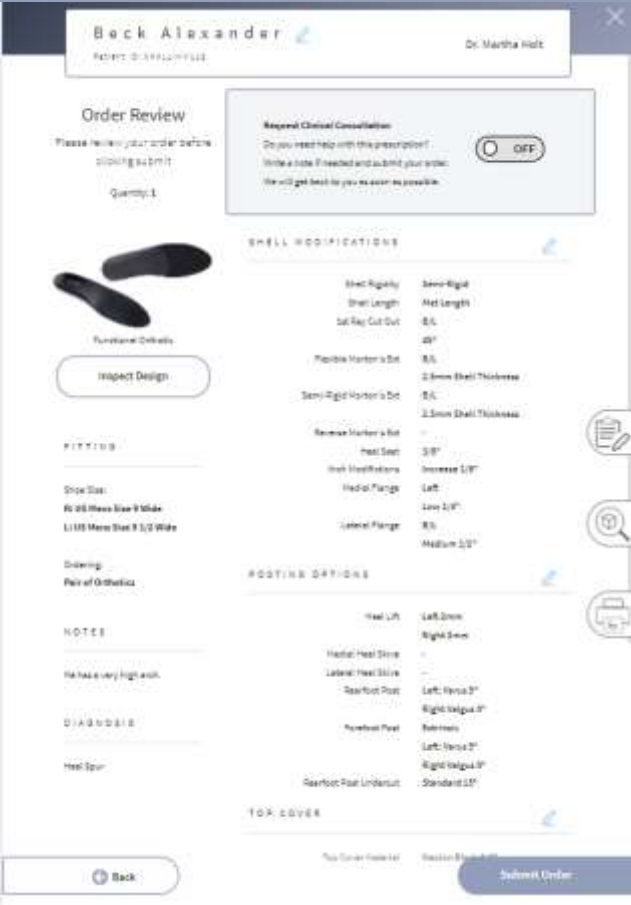

Review your order one last time.

Click Submit Order when the order is ready to send into production